

OFFICE KERSTEN GEERS DAVID VAN SEVEREN  
MULLER VAN SEVEREN

# RASTERS collection



**bd**

Rasters is a modular furniture collection built around a grid system used by architects and engineers to establish order and proportion in space. Designed by OFFICE Kersten Geers David Van Severen and Muller Van Severen, it was originally conceived for Bottega Veneta's headquarters in Milan before evolving into a versatile system of cabinets and paravents suited to domestic, professional, and hybrid environments. Constructed from responsibly sourced steamed beech, the system forms a continuous wooden lattice while black polyamide connectors allow for configurational freedom and continuous horizontal expansion while maintaining structural clarity.

As part of the collection, Rasters cabinets function as modular storage units, with powder-coated steel doors, drawers, and back panels that introduce colour as visual anchors within the grid. Rasters paravents are freestanding spatial dividers that structure and define space without enclosing it. They can incorporate shelves, tables, and hanging elements for working, displaying, or storing, while a cylindrical rail allows objects to be suspended within the framework. Together, the system organises space through openness, supporting multiple ways of inhabiting it.

# Rasters







RASTERS CABINETS

OFFICE KERSTEN GEERS DAVID VAN SEVEREN  
MULLER VAN SEVEREN







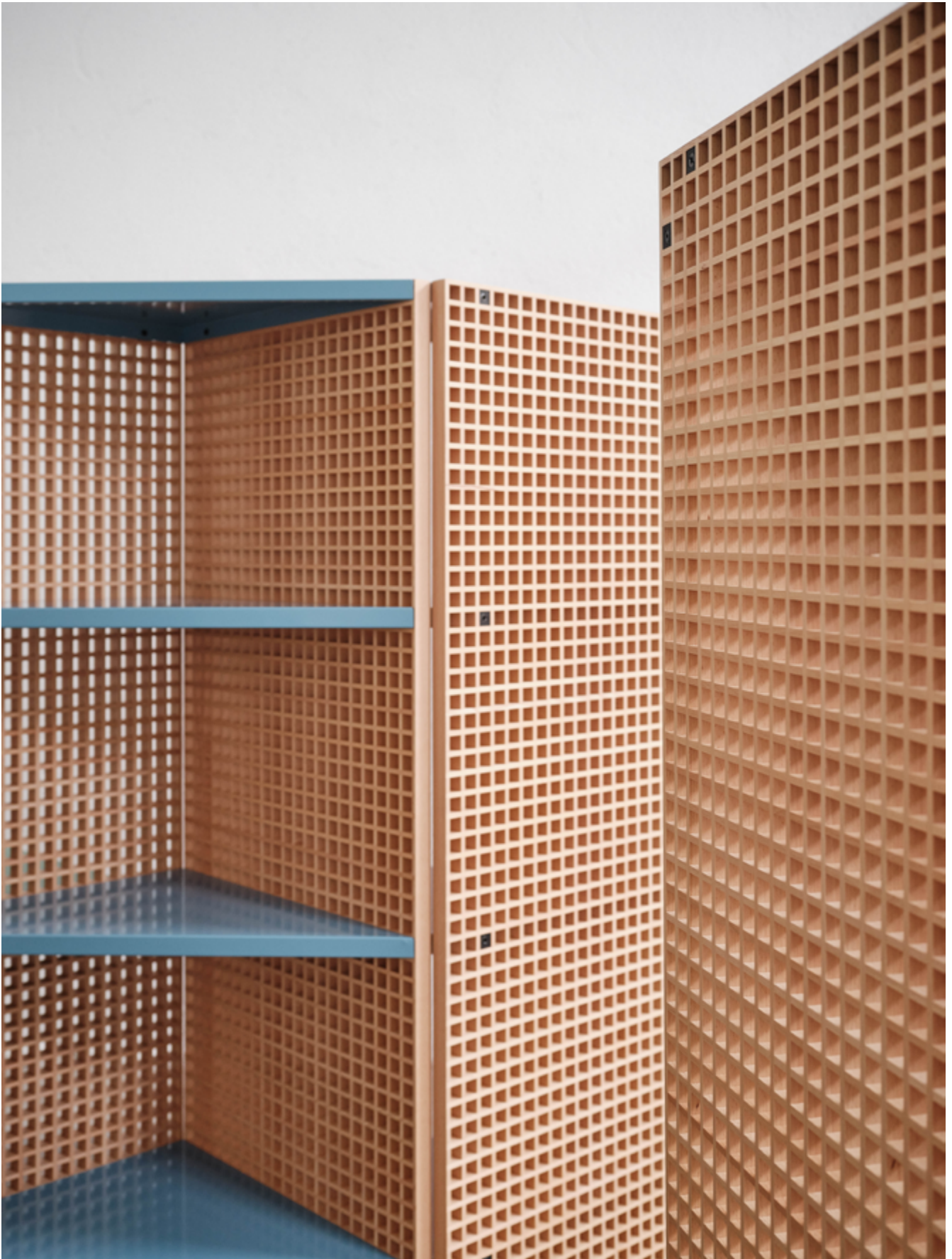







CABINETS

FINISHES

Rasters Cabinets is a modular cabinet system composed of open structural modules designed to be combined laterally, using eccentric fittings and custom-made nylon components, allowing configurations of up to four modules in different heights. When creating a cabinet, modules of different heights can be combined within the same composition.

The base module consists of an open box construction, without front or back enclosure in steamed beech wood. Side panels are made of lattice structures composed of solid beech slats, 7 mm thick, with square free openings of 23 x 23 mm. Top and bottom panels are made of 30 mm MDF veneered in steamed beech. All is water-based matte varnish finished.

The system does not include a back panel by default. Structural stability is ensured by accessories with back panels or by rear cross braces, which are mandatory every two modules when no back accessories are used.

Steel feet with integrated levelling glides are included. Feet are powder-coated in matte black (RAL 9005).

DESIGNERS



OFFICE KERSTEN GEERS DAVID VAN SEVEREN  
MULLER VAN SEVEREN

All metal accessories are powder coated in the following colours:

- Light grey (RAL 7044)
- Off-white (RAL 9001)
- Light blue (RAL 5024)
- Green (RAL 6016)
- Red (RAL 3000)

MEASUREMENTS

EXAMPLE 1

- 1u. - Base module S
- 1u. - Extra module S
- 1u. - Drop down door + backboard

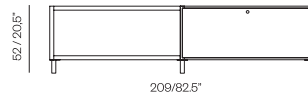

EXAMPLE 2

- 1u. - Base module S
- 2u. - Extra module S
- 2u. - Drawer + backpanel

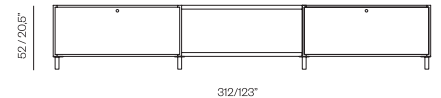

EXAMPLE 3

- 1u. - Base module M
- 1u. - Extra module M
- 1u. - Cross brace M
- 2u. - Shelves

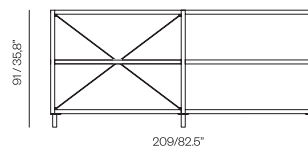

EXAMPLE 4

- 1u. - Base module M
- 2u. - Extra module M
- 1u. - Cross brace M
- 3u. - Shelves

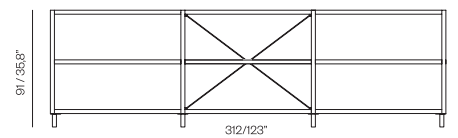

EXAMPLE 5

- 1u. - Base module L
- 2u. - Extra module L
- 6u. - Shelves
- 1u. - Doors L + backpanel
- 1u. - Drawer + backpanel
- 1u. - Drop down door + backpanel

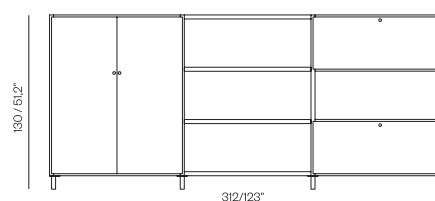

EXAMPLE 6

- 1u. - Base module XL
- 2u. - Extra module XL
- 8u. - Shelves
- 1u. - Doors XL + backpanel

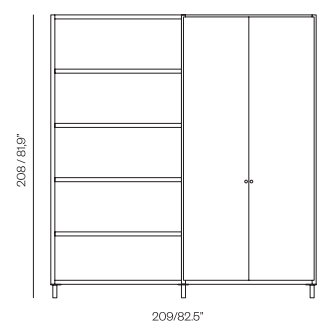

PARAVENTS

FINISHES

Rasters Paravants is a freestanding screen system composed of lattice panels arranged at 90° angles, creating self-supporting configurations. Grids can be combined in sequences of three or five units. The grids are made of lattice structures in steamed beech wood, composed of solid beech slats 7 mm thick with square free openings of 23 × 23 mm. Finish is water-based varnish matte. Panels are connected at 90° using small triangular steel connectors finished in matte black powder coating. The screens are fixed structures and do not fold. Height is defined by the lattice panels and the system stands on adjustable nylon glides.

Accessories:

Rectangular shelf, Triangular shelf, Square table, Cylindrical hanging rail

Shelves and table are made of folded steel sheet. The hanging rail is made of steel tube.

Accessories can be mounted between two panels connected at 90°, occupying the opening created between them.

All metal accessories are powder coated in the following colours:

- Light grey (RAL 7044)
- Off-white (RAL 9001)
- Light blue (RAL 5024)
- Green (RAL 6016)
- Red (RAL 3000)

DESIGNERS



OFFICE KERSTEN GEERS DAVID VAN SEVEREN  
MULLER VAN SEVEREN

MEASUREMENTS

EXAMPLE 1 - 3 GRID PARAVANT

- 3u. - Vertical grids
- 2u. - Triangular shelves
- 1u. - Rectangular shelf
- 1u. - Square Table
- 1u. - Hanging rail

SIDE A

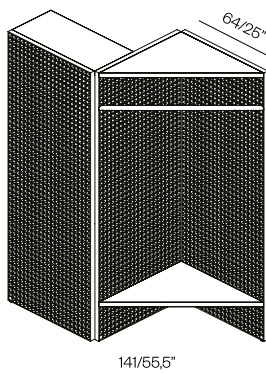

SIDE B

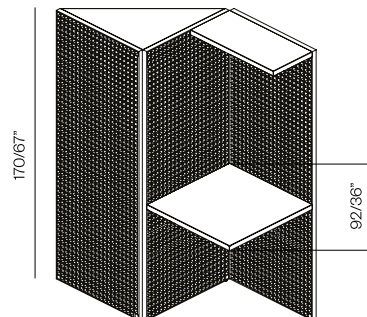

EXAMPLE 2 - 5 GRID PARAVANT

- 5u. - Vertical grids
- 11u. - Triangular shelves
- 1u. - Hanging rail

SIDE A

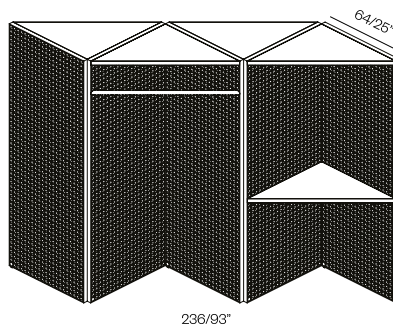

SIDE B

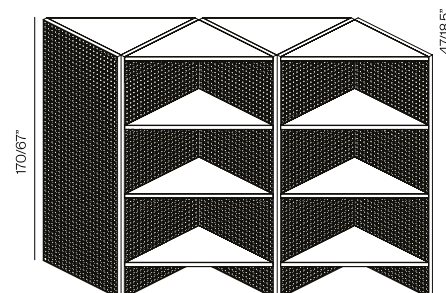

FINISHES

---

POWDER COATED



GREEN RAL 6016



LIGHT BLUE RAL 5024



LIGHT GREY RAL 7044

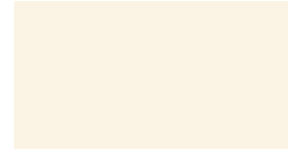

OFF-WHITE RAL 9091



RED RAL 3000



DESIGN SINCE 1972

BD BARCELONA  
RAMON TURRÓ 126, 08005 BARCELONA (SPAIN)  
(+34) 934 586 909  
SALES@BDBARCELONA.COM

BDBARCELONA.COM